



DAKOTA™

Now Featuring **SMARTKEY®**



Security at a Value

Features SmartKey® Re-key Technology

ANSI/BHMA Grade 3 Certified Quality & Security

Lifetime Mechanical Warranty

Kwikset

DAKOTA™

Specifications:

Door Prep	Cross Bore 2-1/8" or 1-1/2". Edge Bore 1". Latch face 1" x 2 1/4".
Backset	Adjustable to 2-3/8" or 2-3/4".
Door Thickness	1-3/4" doors standard.
Cylinder	SmartKey or traditional 5-Pin, Pin & Tumbler.
Faceplates	1" x 2-1/4". Specify round corner, square corner or drive-in.
Strikes	Deadbolt 1" x 2-1/4". Specify round corner or square corner. Other options available. Handle 2-1/4" full lip. Specify round corner or square corner. Other options available.
Bolt	1" throw deadbolt latch, 1/2" throw handle latch.
Door Handing	Reversible for right or left-hand doors.
ANSI/BHMA	Deadbolt is A156.5 Grade 3.

SMARTKEY featuring BumpGuard™:

EASILY RE-KEY IN THREE EASY STEPS



1
Insert functioning key and turn 1/4 turn clockwise.



2
Insert and remove the SmartKey learn tool. Remove functioning key.



3
Insert new key and turn 1/2 turn counter-clockwise. Your lock is now re-keyed!

Finishes:



Satin Nickel (15)

Brushed Chrome (26D)

Polished Brass (3)

Antique Brass (5)

Antique Nickel (15A)

Venetian Bronze (11P)

Functions:

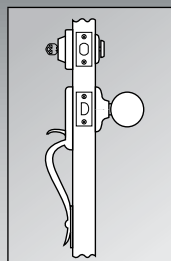

Handleset with Single Cylinder Deadbolt:
Latch bolt operated by thumb piece outside and grip inside. Deadbolt operated by key outside and thumb turn inside.

687 Exterior Pack, Single Cylinder
604 Interior Pack, Single Cylinder

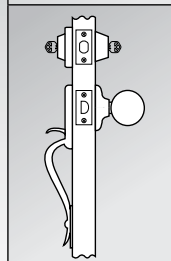

Handleset with Double Cylinder Deadbolt:
Latch bolt operated by thumb piece outside and grip inside. Deadbolt operated by key both sides.

689 Exterior Pack, Double Cylinder
605 Interior Pack, Double Cylinder

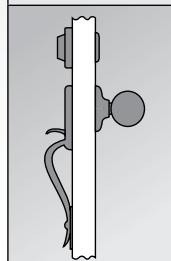

Dummy Handleset with Dummy Deadbolt:
Handle and grip act as a pull only. For inactive leaf of double doors. No operation.

699 Exterior Pack, Dummy
606 Interior Pack, Dummy

NOTE: All Kwikset handsets are sold Less Interior Pack (LIP) only.

Dimensions:

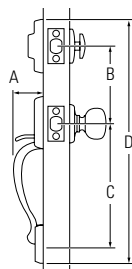

Design	A	B	C	D
Dakota™	2 1/4"	5 1/2"	8 13/32"	17 5/8"